

J1- JANELA MAXIM-AR- 80x60

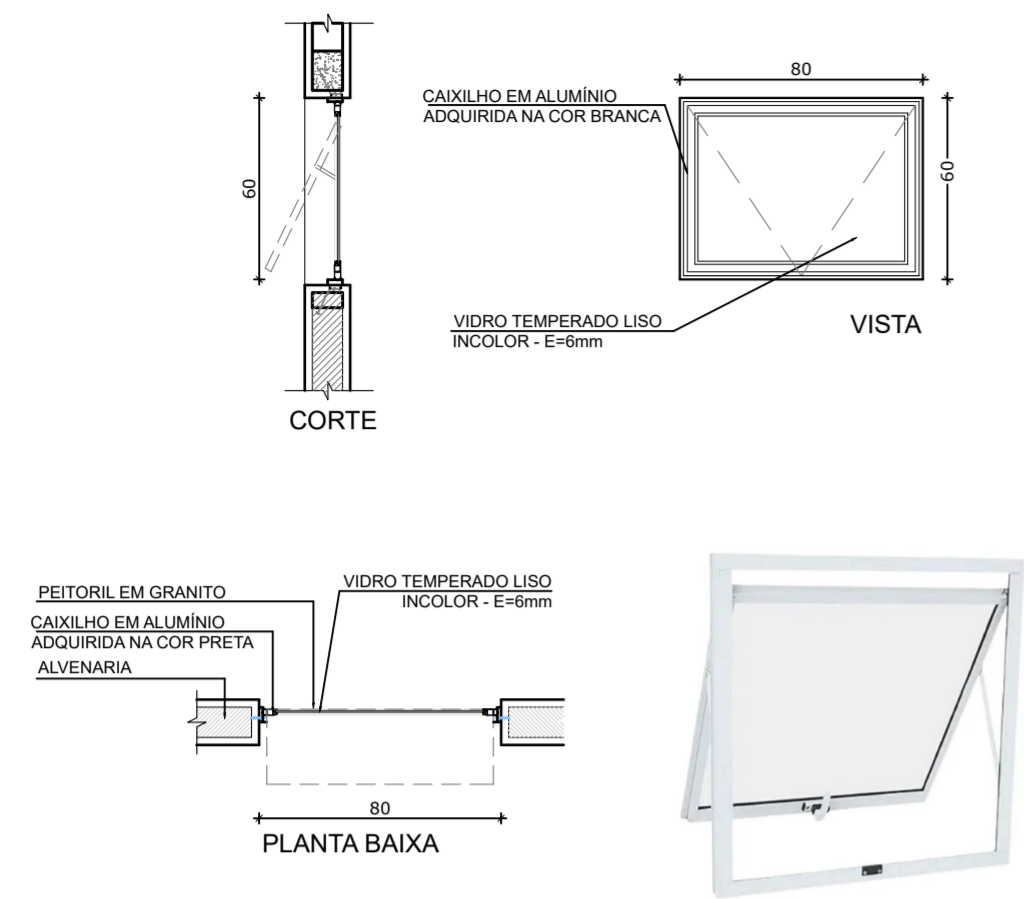

J2- JANELA DE CORRER - 140x100

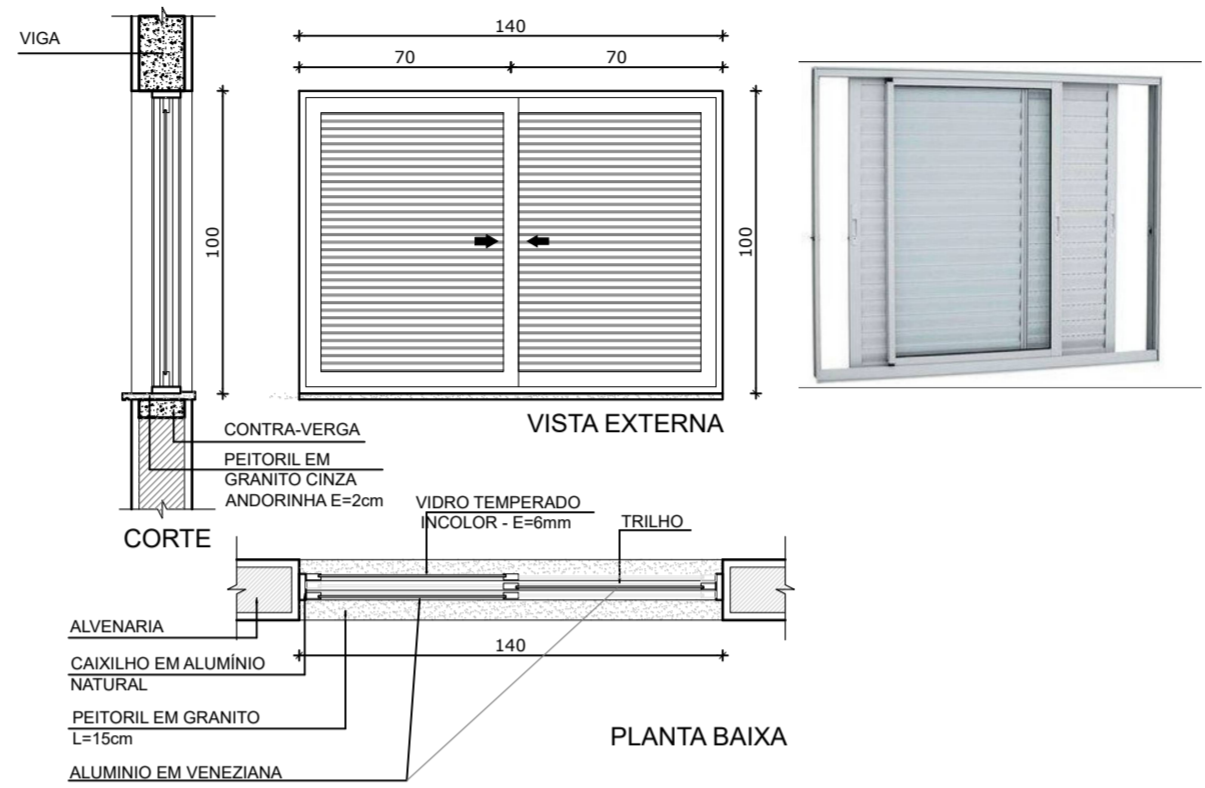

P1- PORTA DE MADEIRA COM VENEZIANA- 80x210

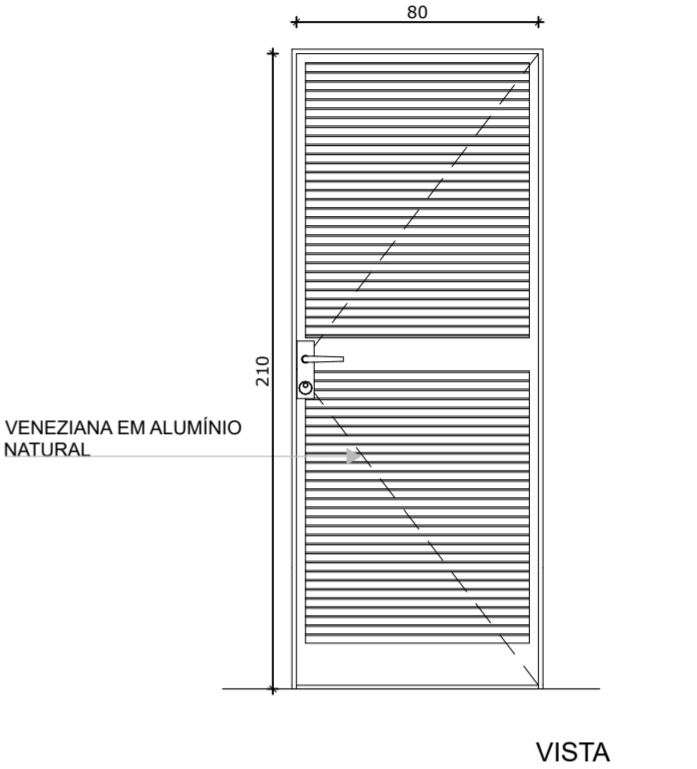

J4- JANELA DE CORRER- 120x100

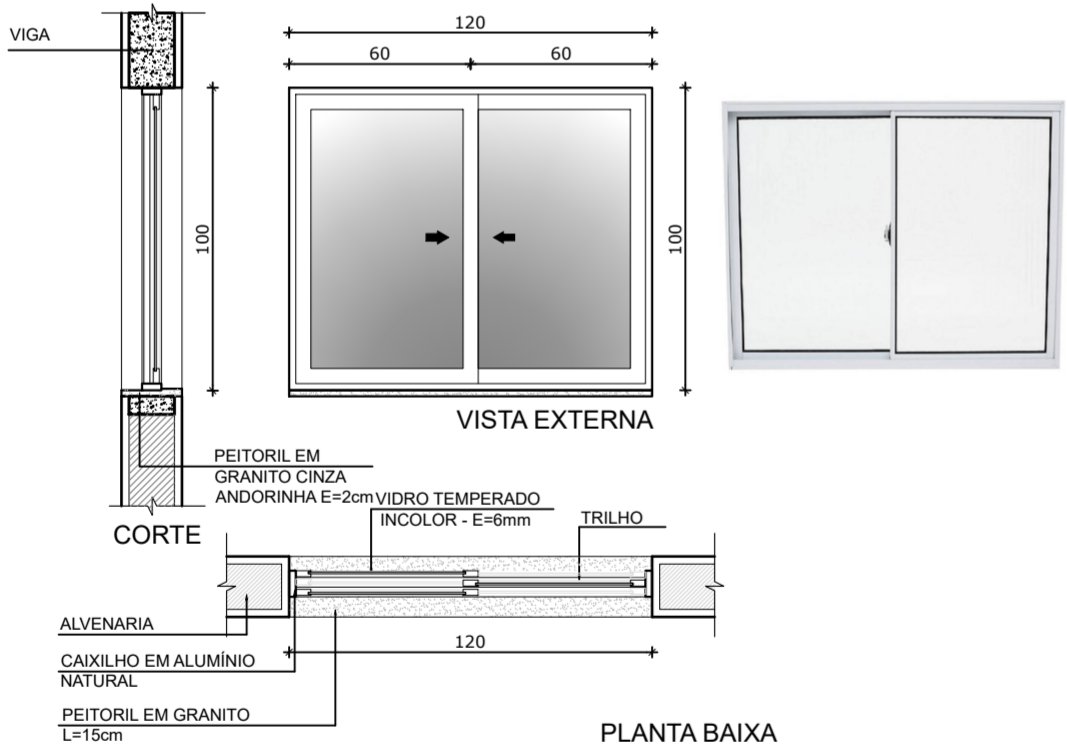

J3- JANELA DE CORRER- 140x100

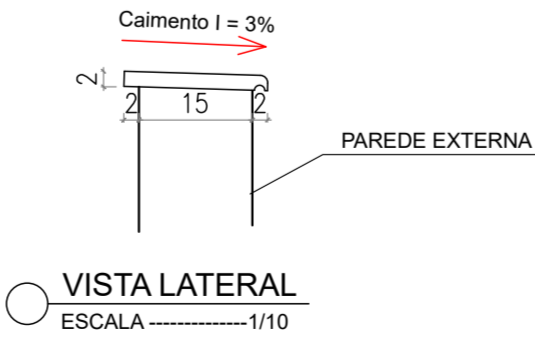
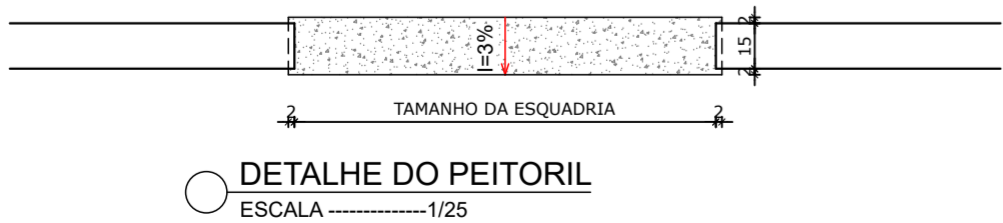
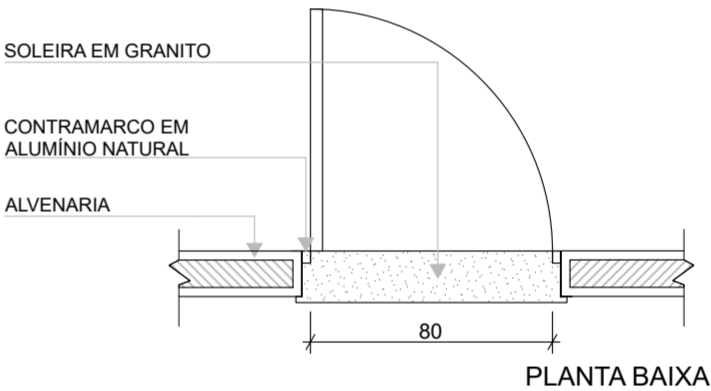
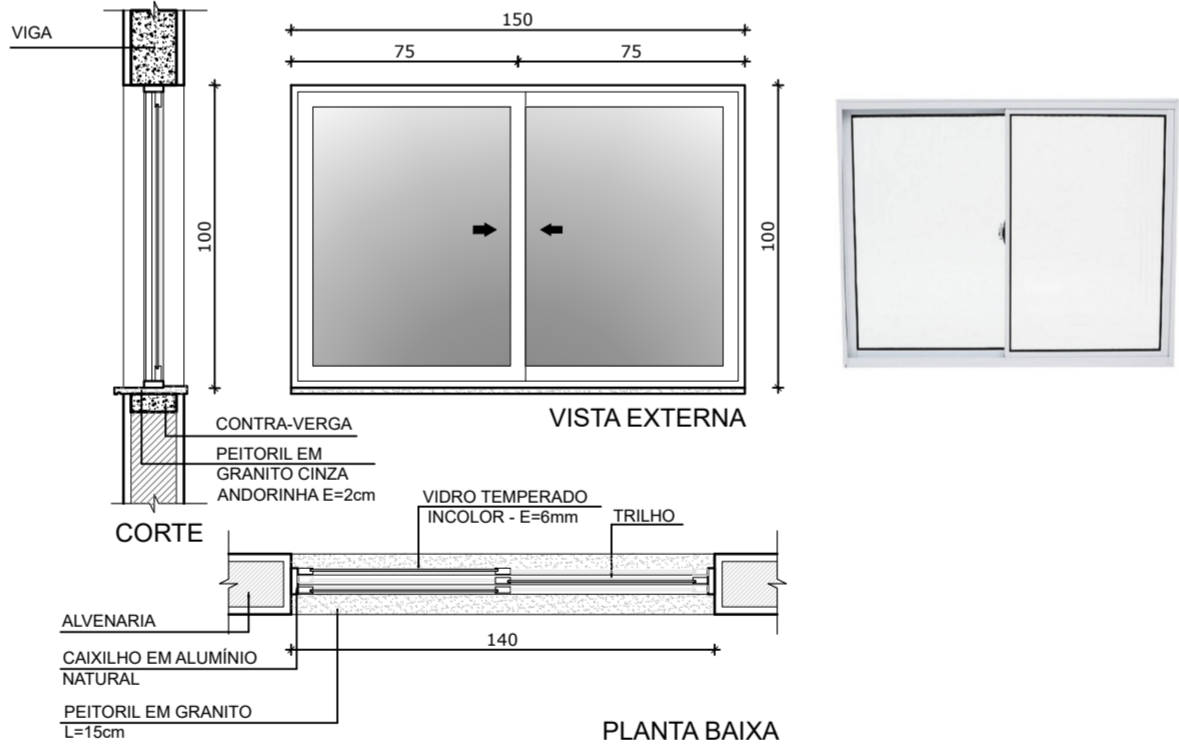

PLANEJAMENTO E ASSESSORIA DE PROJETOS TÉCNICOS LTDA.

CLIENTE: PREFEITURA MUNICIPAL DE AROAZES - PI		LOCALIDADE: ZONA URBANA	
PROJETO: CONSTRUÇÃO DE UNIDADES HABITACIONAIS NO MUNICIPIO DE AROAZES - PI		ESCALA: 1/50	
CONVÊNIO Nº: 970830- MINISTÉRIO DAS CIDADES/ P. M. DE AROAZES (PI)		DESENHO/CAD: ANA VIANA	
DESENHO: DETALHE DAS ESQUADRIAS		FORMATO: A2	
PROJETISTA: Danilo de Oliveira Soares Engenheiro Civil RN: 1915244544		PRANCHA Nº: ARQ.05/07	
DADOS DE CAMPO: TOPOGRAFO		DATA: 2025	
REV.: 00		PRANCHA Nº: ARQ.05/07	